

EN ORIGINAL INSTRUCTIONS

IMPORTANT - These instructions are for your safety.
Please read through them thoroughly prior to handling
the product and retain them for future reference.

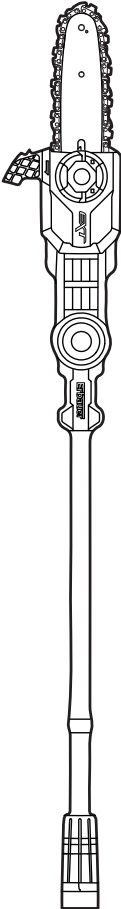

EN Parts



01. x1

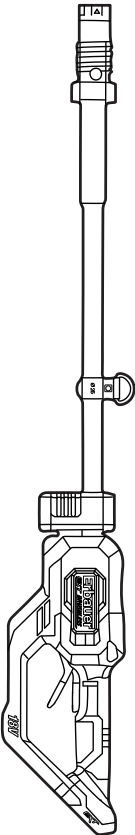

02. x1



03. x1

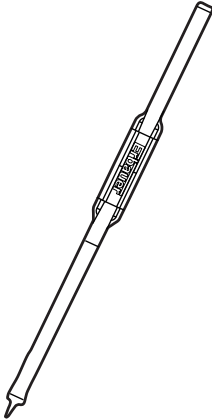

04. x1



05. x1

EN You will need

x1



EN Contents

EN	
Product description	4
Safety	5
Technical specification	20
Before you start	22
Functions & Settings	29
Operation	30
Care and maintenance	35
Guarantee	42
Declaration of conformity	44

EN Product Description

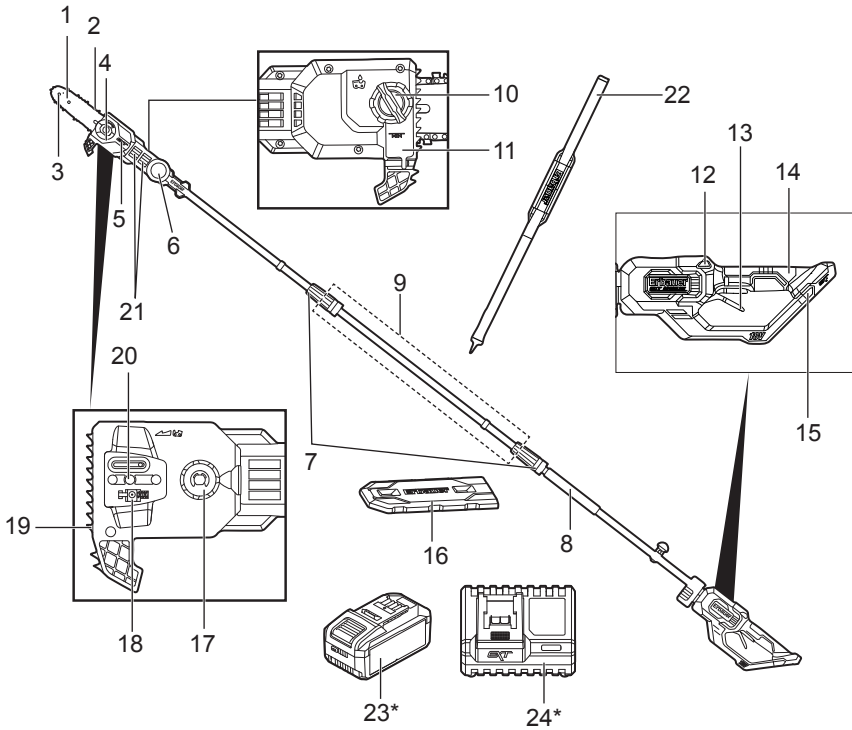

- | | | | |
|-----|------------------|------|----------------------|
| 1. | Guide bar | 13. | On/off switch |
| 2. | Saw chain | 14. | Rear handle |
| 3. | Sprocket wheel | 15. | Battery docking port |
| 4. | Side cover knob | 16. | Guide bar cover |
| 5. | Side cover | 17. | Drive sprocket |
| 6. | Head lock button | 18. | Tension pin |
| 7. | Threaded sleeve | 19. | Anti-slip serration |
| 8. | Gripping surface | 20. | Mounting bolt |
| 9. | Extension pole | 21. | Air vents |
| 10. | Oil tank cap | 22. | Harness |
| 11. | Oil tank | 23*. | Battery pack |
| 12. | Lock-off button | 24*. | Charger |

NOTE: * This may not be included in the supply scope.



General power machine safety warnings



WARNING! Read all safety warnings, instructions, illustrations and specifications provided with this machine. *Failure to follow all instructions listed below may result in electric shock, fire and/or serious injury.*

Save all warnings and instructions for future reference

The term “machine” in the warnings refers to your mains-operated (corded) machine or battery-operated (cordless) machine.

Work area safety

- a) **Keep work area clean and well lit.** *Cluttered or dark areas invite accidents.*
- b) **Do not operate machines in explosive atmospheres, such as in the presence of flammable liquids, gases or dust.** *Machines create sparks which may ignite the dust or fumes.*
- c) **Keep children and bystanders away while operating a machine.** *Distractions can cause you to lose control.*

Electrical safety

- a) **Machine plugs must match the outlet. Never modify the plug in any way. Do not use any adapter plugs with earthed (grounded) machines.** *Unmodified plugs and matching outlets will reduce risk of electric shock.*

- b) **Avoid body contact with earthed or grounded surfaces such as pipes, radiators, ranges and refrigerators.** *There is an increased risk of electric shock if your body is earthed or grounded.*
- c) **Do not expose machines to rain or wet conditions.** *Water entering a machine will increase the risk of electric shock.*
- d) **Do not abuse the cord. Never use the cord for carrying, pulling or unplugging the machine. Keep cord away from heat, oil, sharp edges or moving parts.** *Damaged or entangled cords increase the risk of electric shock.*
- e) **When operating a machine outdoors, use an extension cord suitable for outdoor use.** *Use of a cord suitable for outdoor use reduces the risk of electric shock.*
- f) **If operating a machine in a damp location is unavoidable, use a residual current device (RCD) protected supply.** *Use of an RCD reduces the risk of electric shock.*

Personal safety

- a) **Stay alert, watch what you are doing and use common sense when operating a machine. Do not use a machine while you are tired or under the influence of drugs, alcohol or medication.** *A moment of inattention while operating machines may result in serious personal injury.*

- b) **Use personal protective equipment. Always wear eye protection.** *Protective equipment such as a dust mask, non-skid safety shoes, hard hat, or hearing protection used for appropriate conditions will reduce personal injuries.*
- c) **Prevent unintentional starting. Ensure the switch is in the off-position before connecting to power source and/or battery pack, picking up or carrying the machine.** *Carrying machines with your finger on the switch or energising machines that have the switch on invites accidents.*
- d) **Remove any adjusting key or wrench before turning the machine on.** *A wrench or a key left attached to a rotating part of the machine may result in personal injury.*
- e) **Do not overreach. Keep proper footing and balance at all times.** *This enables better control of the machine in unexpected situations.*
- f) **Dress properly. Do not wear loose clothing or jewellery. Keep your hair and clothing away from moving parts.** *Loose clothes, jewellery or long hair can be caught in moving parts.*
- g) **If devices are provided for the connection of dust extraction and collection facilities, ensure these are connected and properly used.** *Use of dust collection can reduce dust-related hazards.*
- h) **Do not let familiarity gained from frequent use of machines allow you to become complacent and ignore machine safety principles.** *A careless action can cause severe injury within a fraction of a second.*

Machine use and care

- a) **Do not force the machine. Use the correct machine for your application.** *The correct machine will do the job better and safer at the rate for which it was designed.*
- b) **Do not use the machine if the switch does not turn it on and off.** *Any machine that cannot be controlled with the switch is dangerous and must be repaired.*
- c) **Disconnect the plug from the power source and/ or remove the battery pack, if detachable, from the machine before making any adjustments, changing accessories, or storing machines.** *Such preventive safety measures reduce the risk of starting the machine accidentally.*
- d) **Store idle machines out of the reach of children and do not allow persons unfamiliar with the machine or these instructions to operate the machine.** *Machines are dangerous in the hands of untrained users.*
- e) **Maintain machines and accessories. Check for misalignment or binding of moving parts, breakage of parts and any other condition that may affect the machine's operation. If damaged, have the machine repaired before use.** *Many accidents are caused by poorly maintained machines.*
- f) **Keep cutting tools sharp and clean.** *Properly maintained cutting tools with sharp cutting edges are less likely to bind and are easier to control.*

- g) **Use the machine, accessories and tool bits etc., in accordance with these instructions, taking into account the working conditions and the work to be performed.** *Use of the machine for operations different from those intended could result in a hazardous situation.*
- h) **Keep handles and grasping surfaces dry, clean and free from oil and grease.** *Slippery handles and grasping surfaces do not allow for safe handling and control of the machine in unexpected situations.*

Battery machine use and care

- a) **Recharge only with the charger specified by the manufacturer.** *A charger that is suitable for one type of battery pack may create a risk of fire when used with another battery pack.*
- b) **Use machines only with specifically designated battery packs.** *Use of any other battery packs may create a risk of injury and fire.*
- c) **When battery pack is not in use, keep it away from other metal objects, like paper clips, coins, keys, nails, screws, or other small metal objects, that can make a connection from one terminal to another.** *Shorting the battery terminals together may cause burns or a fire.*
- d) **Under abusive conditions, liquid may be ejected from the battery; avoid contact. If contact accidentally occurs, flush with water. If liquid contacts eyes, additionally seek medical help.** *Liquid ejected from the battery may cause irritation or burns.*

- e) **Do not use a battery pack or machine that is damaged or modified.** *Damaged or modified batteries may exhibit unpredictable behaviour resulting in fire, explosion or risk of injury.*
- f) **Do not expose a battery pack or machine to fire or excessive temperature.** *Exposure to fire or temperature above 130°C may cause explosion.*
- g) **Follow all charging instructions and do not charge the battery pack or machine outside the temperature range specified in the instructions.** *Charging improperly or at temperatures outside the specified range may damage the battery and increase the risk of fire.*

Service

- a) **Have your machine serviced by a qualified repair person using only identical replacement parts.** *This will ensure that the safety of the machine is maintained.*
- b) **Never service damaged battery packs.** *Service of battery packs should only be performed by the manufacturer or authorized service providers.*

Pole saw safety warnings

- a) **Keep all parts of the body away from the saw chain. Do not remove cut material nor hold material to be cut when saw chain is moving. Make sure the machine is switched off and the battery is removed when clearing jammed material.** *A moment of inattention while operating the pole saw may result in serious personal injury.*

- b) **Hold the machine by insulated gripping surfaces only, because the saw chain may contact hidden wiring.** *Saw chains contacting a “live” wire may make exposed metal parts of the machine “live” and could give the operator an electric shock.*
- c) **Maintain a firm grip, with both hands on the pole saw and position your body and arm to allow you to resist any kickback forces.** *Kickback forces can be controlled by the operator, if proper precautions are taken. Do not let go of the pole saw.*
- d) **When cutting a branch be alert for kickback.** *When the branch is broached it can bend down and jam the saw chain.*
- e) **Carry the pole saw switched off, always with both hands and the saw chain with bar cover fitted, away from you.** *Proper handling of the pole saw will reduce the likelihood of accidental contact with the moving saw chain.*
- f) **Do not operate a pole saw in a tree.** *Operation of a pole saw while climbing or situated in a tree may result in personal injury.*
- g) **Always keep proper footing and operate the pole saw only, when standing on fixed, secure and ground level surface.** *Slippery or unstable surfaces such as ladders may cause a loss of balance or control of the pole saw.*
- h) **Follow instructions for oiling, chain tensioning and changing accessories.** *Improperly tensioned or lubricated chain may either break or increase the chance for kickback.*

- i) **Thoroughly inspect the area for wildlife where the machine is to be used.** *Wildlife may be injured by the machine during operation.*
- j) **Keep handles dry, clean, and free from oil and grease.** *Greasy, oily handles are slippery causing loss of control.*
- k) **Cut wood only. Don't use pole saw for purposes not intended. For example: do not use pole saw for cutting plastic, masonry or non-wood building materials.** *Use of the pole saw for operations different than intended could result in a hazardous situation.*

l) **Causes and operator prevention of kickback:**

Kickback may occur when the nose or tip of the guide bar touches an object, or when the wood closes in and pinches the saw chain in the cut.

Tip contact in some cases may cause a sudden reverse reaction, kicking the guide bar up and back towards the operator.

Pinching the saw chain along the top of the guide bar may push the guide bar rapidly back towards the operator.

Either of these reactions may cause you to lose control of the pole saw which could result in serious personal injury. As a pole saw user, you should take several steps to keep your cutting jobs free from accident or injury. Kickback is the result of machine misuse and/ or incorrect operating procedures or conditions and can be avoided by taking proper precautions as given below:

-

- **When cutting a branch be alert for kickback.** When the branch is broached it can bend down and jam the saw chain.
- **Only use replacement saw chains and bars specified by the manufacturer.** Incorrect replacement of saw chains and bars may cause chain breakage and/ or kickback.
- **Always wait until the machine has come to a complete stop, and remove the battery before placing it down.** The saw chain can jam or kickback and lead to loss of control over the garden machine.
- Switch off the pole saw when changing the working position.

Additional safety warnings for pole saw

Some regions have regulations that restrict the use of the product. Check with your local authority for advice.

Always use the transport cover for the cutting attachment during transport and storage.

Always secure the machine during transport to prevent loss of fuel, damage or injury.

Need daily inspection before use and after dropping or other impacts in order to identify any significant damage or defects.

Additional safety warnings for battery pack

- a) **Battery pack needs to be charged before use.** *Always refer to the charger's instruction and charge it properly.*
- b) **Remove the battery pack from the product when not in use.**

- c) **Don't maintain the battery pack on the charger when not in use.**
- d) **After extended periods of storage, it may be necessary to charge and discharge the battery pack several times to obtain the maximum performance.**
- e) **Longer life and better performance can be obtained if the battery is charged when the air temperature is between 18°C and 24°C. Do not charge the battery in air temperature below 5°C or above 40°C. This is important as it can prevent serious damage to the battery.**
- f) **Do not charge battery in a damp or wet location. Following this rule will reduce the risk of electric shock.**
- g) **Do not disassemble the battery and avoid mechanical damage to the battery. Risk of short circuit and fumes may be emitted. Ensure fresh air and seek medical assistance in the event of discomfort.**
- h) **When disposing of battery pack, keep the battery pack of different electrochemical systems separate from each other.**

Vibration and noise reduction

To reduce the impact of noise and vibration emission, limit the time of operation, use low-vibration and low- noise operating modes as well as wear personal protective equipment.

Take the following points into account to minimize the vibration and noise exposure risks:

1. Only use the product as intended by its design and these instructions.

2. Ensure that the product is in good condition and well maintained.
3. Use correct application tools for the product and ensure they in good condition.
4. Keep tight grip on the handles/grip surface.
5. Maintain this product in accordance with these instructions and keep it well lubricated (where appropriate).
6. Plan your work schedule to spread any high vibration tool use across a longer period of time.

The European Physical Agents (Vibration) Directive has been brought in to help reduce hand arm vibration syndrome injuries to users of product's with vibration emission. The directive requires manufacturers and suppliers to provide indicative vibration test results to enable users to make informed decisions as to the period of time a product can be used safely on a daily basis and the choice of tool. Further advice can be found at www.hse.gov.uk

Emergency

Familiarise yourself with the use of this product by means of this instruction manual. Memorise the safety directions and follow them to the letter. This will help to prevent risks and hazards.

1. **Always be alert when using this product, so that you can recognise and handle risks early. *Fast intervention can prevent serious injury and damage to property.***

2. **Switch off and disconnect from the power supply if there are malfunctions.** *Have the product checked by a qualified professional and repaired, if necessary, before you operate it again.*

Residual risks

Even if you are operating this product in accordance with all the safety requirements, potential risks of injury and damage remain. The following dangers can arise in connection with the structure and design of this product:

1. Health defects resulting from vibration emission if the product is being used over long periods of time or not adequately managed and properly maintained.
2. Injuries and damage to property due to broken accessories or the sudden impact of hidden objects during use.
3. Danger of injury and property damage caused by flying objects.
4. Prolonged use of this product expose the operator to vibrations and may produce 'whitefinger' disease. In order to reduce the risk, please wear gloves and keep your hands warm. If any of the 'whitefinger' symptoms appear, seek medical advice immediately. 'Whitefinger' symptoms include: numbness, loss of feeling, tingling, pricking, pain, loss of strength, changes in skin colour or condition. These symptoms normally appear in the fingers, hands or wrists. The risk increases at low temperatures.



WARNING! This product produces an electromagnetic field during operation! This field may under some circumstances interfere with active or passive medical implants! To reduce the risk of serious or fatal injury, we recommend persons with medical implants to consult their doctor and the medical implant manufacturer before operating this product!

Symbols

On the product, the rating label and within these instructions you will find among others the following symbols and abbreviations. Familiarise yourself with them to reduce hazards like personal injuries and damage to property.

V	Volt, (direct current voltage)	/min or min ⁻¹	Per minute
mAh	Milliampere per hour	mm	Millimetre
m	Metre	kg	Kilogram
l	Litre	m/s ²	Metres per second squared
cm ³	Cubic centimetre	dB(A)	Decibel (A-rated)
yyWxx	Manufacturing date code: year of manufacturing (20yy) and week of manufacturing (Wxx).		



Read the instruction manual.



Caution / Warning.



Wear eye protection!



Wear hearing protection!



Guide bar length: 200 mm



Wear protective gloves!



Wear safety footwear



Wear safety helmet!



Wear face protection!



Wear tight-fitted protective clothes.



Use appropriate protection for foot-leg and hand-arm.



Keep the pole mounted powered pruner a sufficient distance away from electrical power lines.



Objects thrown by the product could hit the user or other bystanders. Always ensure that other people and pets remain at a safe distance from the product when it is in operation. In general, children must not come near the area where the product is. Minimum distance 15m.



Kickback! Tip contact may cause the guide bar to move suddenly upward and backwards what may cause serious injury to user.



Contact of the guide bar tip with any object should be avoided.



Always use the product with two hands. Do not use one handed when operating the product.



Do not use in rain or wet conditions.



Guaranteed sound power level value in XX dB(A).



Chain oil fill



Correct direction of cutting-teeth



Cutting of fingers or hand.



Danger of falling objects.



WEEE symbol. Waste electrical products should not be disposed of with household waste. Please recycle where facilities exist. Check with your Local Authority or local store for recycling advice.



Crossed out dust bin. Batteries and battery packs should not be disposed of with household waste. Please recycle where facilities exist. Check with your Local Authority or local store for recycling advice.



Do not dispose of battery packs in rivers or immerse in water.



Do not dispose of battery packs in fire. They will explode and cause injury.



Do not expose battery packs to heat in excess of 40 °C.

Do not charge or store the battery pack in temperatures below 5 °C (41 °F) and above 40 °C (104°F).



The product complies with the applicable Your product European directives and an evaluation method of conformity for these directives was done.



UK Conformity Assessed.

Rating label explanation

Cordless Pole Saw: ERI1020PLS

ER= Brand name(Erbauer)

I=18V Lithium-Ion

1020=Serial number

PLS=Pole Saw

EN Technical specifications





General:

> Rated voltage	36V
> Rated no load speed n 0	23,000 rpm
> Machine length (without extension pole)	2.2 m
> Machine length (with extension pole)	3 m
> Oil tank capacity	100 ml
> Pivot angle	0°, 30°
> Weight (without battery pack ,with empty tanks, without cutting attachment and harness)	approx. 3.3 kg
>Weight(cutting attachment and harness)	approx. 0.5kg
>Ambient temperature range for machine and battery use	0°C to 40°C



Guide bar and saw chain:

> Guide bar length	20 cm
> Chain pitch	8.255mm (0.325")
> Chain gauge	1.1mm (0.043")
> Number of Drive Links	38
> Max. chain speed	10 m/s

Battery pack (may not be included)

> Model no.	ERT1044BAT	ERT1045BAT
> Type	Li-Ion	Li-Ion
> Voltage	18V  / 36V 	18V  / 36V 
> Capacity	8 Ah / 4Ah	6 Ah / 3 Ah
> Weight	approx. XX kg	approx. XX kg

Charger for battery pack (may not be included)

> Model no.	ERT1047CHR	ERT1046CHR
> Rated input	220-240 V~ 50/60 Hz	220-240 V~ 50/60 Hz
> Rated output	21 V  12 A	21 V  x2 12 A x2
> Ambient temperature range for charger and battery use	5°C to 40°C	5°C to 40°C

Sound values:

> Sound pressure level L_{pA}	78 dB(A)
> Uncertainty K_{pA}	3dB(A)
> Measured sound power level L_{WA}	93dB(A)
Guaranteed sound power level L_{WA}	94dB(A)
> Uncertainty K_{WA}	1.3dB(A)
> Vibration value a_h	Main handle 0.7m/s ² Auxiliary handle 0.8m/s ²
> Uncertainty K	1.5m/s ²

The sound value(s) have been determined according to noise test code given in EN 62841-1 and EN ISO 11680-1, using the basic standards EN ISO 22868 and EN ISO 3744. The sound intensity level for the operator may exceed 80 dB(A) and ear protection measures are necessary.

The declared total vibration value(s) and the declared noise emission value(s) have been measured in accordance with a standard test method and may be used for comparing one tool with another;

The declared total vibration value(s) and the declared noise emission value(s) may also be used in a preliminary assessment of exposure.



WARNING! The vibration and noise emission during actual use of the power tool can differ from the declared total value depending on the ways in which the tool is used especially what kind of workpiece is processed;

The need to identify safety measures to protect the operator that are based on an estimation of exposure in the actual conditions of use (taking account of all parts of the operating cycle such as the times when the tool is switched off and when it is running idle in addition to the trigger time).



EN Before you start

Unpacking

1. Unpack all parts and lay them on a flat, stable surface.
2. Remove all packing materials and shipping devices if applicable.
3. Make sure the delivery contents are complete and free of any damage. If you find that parts are missing or show damage do not use the product but contact your dealer. Using an incomplete or damaged product represents a hazard to people and property.
4. Ensure that you have all the accessories and tools needed for assembly and operation. This also includes suitable personal protective equipment.



WARNING! The product and the packaging are not children's toys! Children must not play with plastic bags, sheets and small parts! There is a danger of choking and suffocation!

You will need

(items not supplied)

Suitable personal protective equipment
Lubricant for pole saw
Battery pack
Charger

(items supplied)

Guide bar cover
Extension pole
Harness



NOTE: The accessories required depend on the intended application. Ask your dealer for advice.

EN Assembly



WARNING! The product must be fully assembled before operation! Do not use a product that is only partly assembled or assembled with damaged parts!



WARNING! Disconnect the battery pack from the machine before making any assembly, adjustments, changing accessories, or storing machine. Such preventive safety measures reduce the risk of starting the machine accidentally.



Follow the assembly instructions step-by-step and use the pictures provided as a visual guide to easily assemble the product!

Before using the product, familiarise yourself with the operating features read the entire instruction manual paying particular attention to the safety rules and operating procedures.

Do not connect the product to battery pack before it is completely assembled!

Removing / installing the guide bar and saw chain

Removing the guide bar and saw chain

1. Make sure the oil tank cap (10) is securely fastened to prevent oil leakage.
2. Place the product on a suitable flat surface with the side cover (5) facing upwards.
3. Wear gloves. Remove the side cover (5) by turning the side cover knob (5) counterclockwise. (Fig. 1) Clean the side cover with a dry cloth.

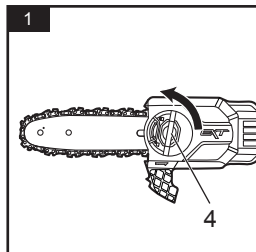

4. Remove the bar and chain. (Fig. 2)

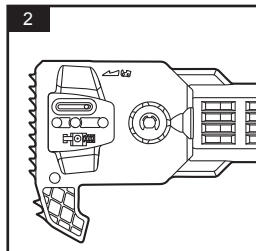

Installing the guide bar and saw chain

1. Use only a guide bar (1) and saw chain (2) according to the technical data of the pole saw.
2. Spread the saw chain (2) out with the cutting edges of the chain pointing in the direction of rotation. Slide the saw chain (2) into the groove around the guide bar (1). Ensure saw chain (2) is installed in correct direction of rotation. (Fig .3)

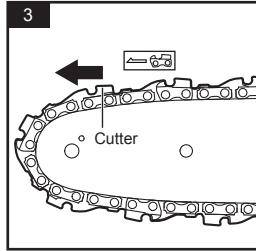

WARNING! The direction of the saw chain 'cutters' must be same as indicated by the symbol and arrow on the guide bar!

3. Align saw chain (2) and the guide bar (1) assembly with the drive sprocket (17) and the mounting bolt (20). Lay the saw chain (2) around the drive sprocket (17) and then lower the guide bar (1) to install it to the mounting bolt (20). Make sure the tension pin is inserted into the lower hole on the guide bar (1). (Fig.4)

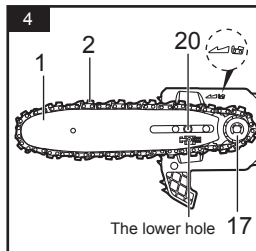

4. The saw chain movement is as indicated by the arrow (Fig. 5). Make sure the saw chain (2) is properly placed over the sprocket wheel (14) of the guide bar (12). (Fig. 5)

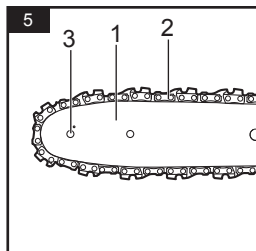

5. Refit the cover (5), fit the rear of cover then front, ensure mounting bolt is located in position. Then fully tighten the side cover knob (4) by turning it clockwise to make sure the chain is correctly tightened (Fig. 6).

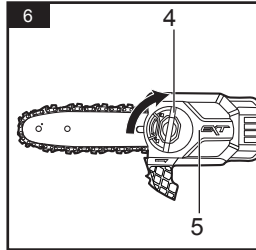

NOTE: If the chain gets loose, turn the side cover knob counterclockwise to release the tension pin, then fully tighten the knob clockwise. The chain will automatically tighten appropriately.

Chain lubrication



WARNING! The product is not filled with chain oil. It is essential to fill the product with chain oil before using it! Never operate the product without chain oil as this will result in extensive damage to the product!

Operating the saw chain dry or with too little chain oil will decrease cutting efficiency, shorten the product life span and cause rapid wear to the saw chain and guide bar from overheating! Insufficient chain oil is evident by smoke or bar discoloration! Adequate lubrication of the saw chain during cut is very important.

1. Place the product on a stable, level surface with the oil tank cap (10) facing upward. We recommend laying a non-flammable sheet under the product.
2. Unscrew and remove the oil tank cap (10) (Fig. 7).

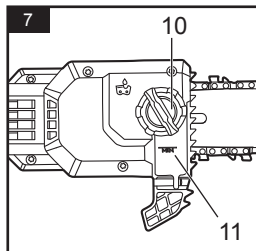

3. Fill suitable lubricant into the tank using an oil funnel fitted with a filter to avoid debris entering the tank. Be careful not to let the oil spill from the opening.



NOTE: In summer use SAE #30; in winter, or if the trees have excessive sap, use SAE #10.



NOTE: Towards the end of the season, it is advisable to put only as much lubricant in the tank as you need for each cut, so that it is completely used up before you store the product.

4. Check the oil level through the translucent oil tank (11) prior to start-up and regularly during operation. Refill oil when the oil level is close to the bottom of tank.
5. Wipe up spilled lubricant with a soft cloth and refit the oil tank cap (10).



NOTE: Always dispose of lubricant, used oil and objects contaminated with them in accordance with local regulations.

Assembling / disassembling the poles

1. Align the raised rib on the saw head pole in the left of the picture with the arrow on the power head pole in the right of the picture and push the saw head pole into the power head pole. (Fig. 8)

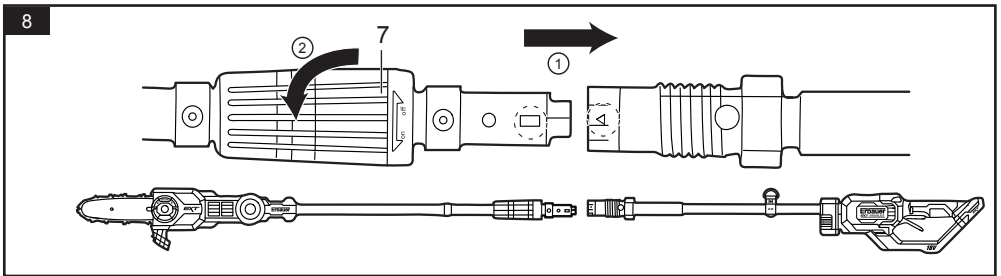

2. Screw the threaded sleeve (7) tightly onto the threaded connection on the saw head pole.
3. Pull on the two poles to verify that they are securely locked in place.
4. Follow the above steps in reverse order to disassemble the poles.



WARNING! Be certain that the threaded sleeve (7) is fully tightened before operating the product; check it periodically for tightness during use to avoid serious personal injury

Assembling / disassembling the extension pole



WARNING! This extension pole is designed to only be used with ERI1020PLS. Never use it with other attachments.

The extension pole (9) increases the machine length by XX cm, extending the cutting range. It should be connected between the pole saw attachment and the power head. A maximum of XX extension poles can be used on one machine.

Follow the process in the section **Assembling / disassembling the poles** to install the extension pole (9) between the pole saw attachment and power head (Fig. 9).

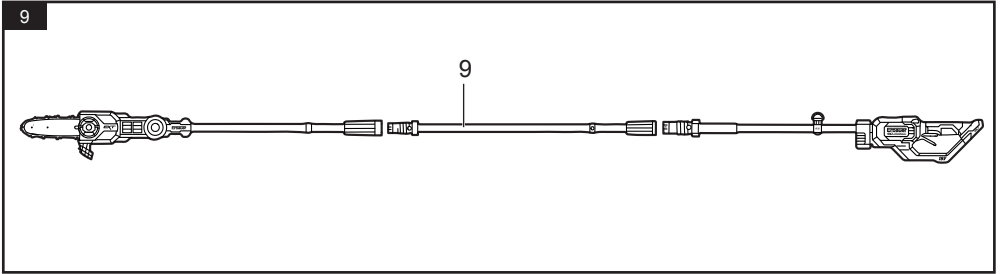

NOTE: Once assembled correctly, the pole saw attachment, extension pole and the power head should not separate when pulled. Always test the connection by pulling them. Repeat the steps above if the pieces can be separated during test.



WARNING! Failure to secure the attachment and power head/extension pole as instructed above could result in serious injury or death.

Harness

The harness (22) helps the operator carry this product.

1. Place the harness (22) over your left shoulder so that it runs over the left shoulder, crossing the chest and back. (Fig. 10).

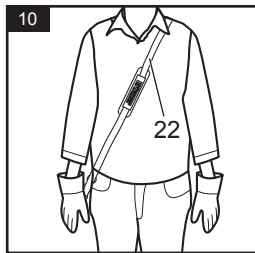

2. Fasten the snap hook on the securing clip (23) on the shaft (Fig. 11).

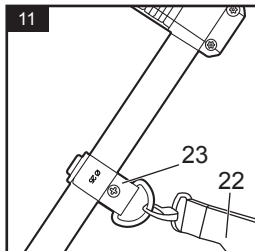

3. The length of the shoulder strap can be adjusted.

- The harness (22) can be buckled or released with shoulder strap loop (23) by the quick-release mechanism.



WARNING! Always attach the product to the harness. Do not carry it only with your hands!

Battery pack

Attaching / releasing the battery pack

- Slide the battery pack into the battery docking port (15) until it is securely locked in position.
- Depress the battery pack release button (24) to release and slide the battery pack out from your tool. (Fig. 12)

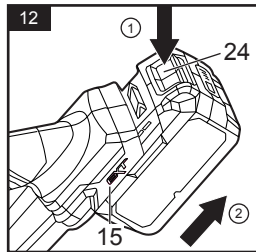

- After recharge, slide the battery pack back into your tool. A simple push and slight pressure will be sufficient.







Charging the battery pack

The battery pack for this product has been shipped in a low charge condition. Charge it fully before first use.

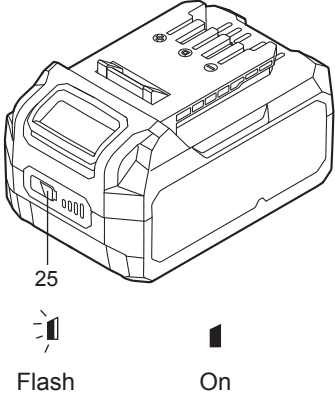
Refer to the charger's instruction manual for the details.

Battery pack power bar

The Li-Ion battery pack is equipped with a power bar (25) which is used to give an indication of the battery pack's remaining charge. Press the power bar button (25) to check battery charge as below. The LED will stay lit for approximately 5 seconds.

	76-100% Charge	
	51-75% Charge	
	26-50% Charge	
	5-25% Charge	
	under 5% Charge	

EN Functions & settings

Intended use

This pole saw ERI1020PLS is designated with a rated voltage of 18 V. The product is intended for cutting limbs with a thickness of max. 200 mm. It must not be used for cutting other materials, such as plastic, stone, metal or wood that contains foreign objects. The product may only be used with the guide bar/saw chain combination stated in these instructions. It is not permitted to use other types or sizes. This product should not be used outside of domestic areas. This product is intended for private domestic use only, not for any commercial trade use. It must not be used for any purposes other than those described.

Switching on/off

1. Ensure the battery pack is assembled on the battery docking port (15).
2. Remove the guide bar cover (16) from the cutting head.
3. Ensure the saw chain (2) does not come into contact with anything before starting the product.
4. Grip the product with both hands, your left hand holding the gripping surface (8) and your right hand holding the rear handle (14). Do not start the product while handling it with one hand.

- Press down the lock-off button (12) with your right thumb, then fully depress the on/off switch (13) with your index fingers and hold it in this position. (Fig. 13)

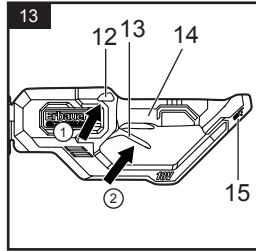

- Release the on/off switch (13) to switch the product off.



WARNING! The product will continue to work for some time even after the motor has been switched off! Wait until it comes to a complete stop before you put the product down!

Pivoting the cutting head

- Stop the motor and remove the battery pack.
- Press down the head lock button (6) from two sides of the cutting head.
- Pivot the cutting head downward until the head lock button (6) pops up to lock the cutting head at the rotated position. (Fig. 14)

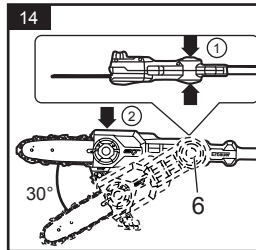

EN Operation

Saw chain stop test



NOTE: Perform the following test before operating your product.

- Hold the gripping surface (8) with the left hand, the rear handle (14) with your right hand.
- Ensure the saw chain (2) does not come into contact anything when switching on.
- Release the on/off switch (13) to switch the product off, the saw chain must come to a stop.



WARNING! If the saw chain shows any signs of moving stop the motor immediately! Wait for all moving parts to stop! Contact a qualified specialist to have a check!

General operation

1. Check the product, its battery pack and charger as well as accessories for damage before each use. Do not use the product if it is damaged or shows wear. Take care of any problem you find or have the product checked by qualified specialist.
2. Double check that the accessories or attachments and the guide bar/ saw chain are properly fixed.
3. Make sure the side cover knob is fully tightened, which ensures that the chain is correctly tensioned.
4. Check the chain oil level, refill if necessary.
5. Check the sharpness of the cutting teeth of the saw chain.
6. Always hold the product on its handle(s)/gripping surface(s). Keep the handle(s)/ gripping surface(s) dry and clean to ensure safe support.
7. Make sure that you have a secure and balanced footing during operation and use with the harness. Watch out for obstacles such as tree stumps, roots, and ditches, which could cause you to trip or stumble.
8. Ensure that the air vents (21) are always unobstructed and clear. Clean them if necessary with a soft brush. Blocked air vents may lead to overheating and damage the product.
9. Switch the product off immediately if you are disturbed while working by other people entering the working area. Always let the product come to complete stop before putting it down.
10. Do not overwork yourself. Take regular breaks to ensure you can concentrate on the work and have full control over the product.
11. Make sure that the object being cut does not exceed the usable cutting length of the pole saw. The tip of guide bar shall always be kept outside the outline of the wood log.
12. Before operating the pole saw, the user should check whether it has been assembled correctly and all the moving parts are running smoothly.
13. While working, ensure that the product does not strike hard objects, as this can cause damage.



WARNING! In some countries regulations define at what time of the day and on what special days products are allowed to be used and what restrictions apply! Ask your community for detailed information and observe the regulations in order to preserve a peaceful neighbourhood and avoid committing administrative offences!

Operating hours

Only operate the product at reasonable hours - not early in the morning, late at night or on weekends/public holidays when people might be disturbed. Inform yourself about local restrictions.

Kickback



WARNING! Beware of kickback! Kickback can lead to dangerous loss of control of the product and result in serious or fatal injury to the operator or anyone standing close by! Always be alert because rotational kickback and pinch kickback are major product operational dangers and the leading cause of most accidents!

1. Kickback is the sudden backward/upward motion of the product, occurring when the chain (at the tip of the chain bar) comes in contact with a log or wood, or when the chain becomes jammed.
2. When kickback occurs the product reacts unpredictably and can cause severe injuries to the operator or bystanders.
3. With a basic understanding of 'kickback', the element of surprise can be reduced or eliminated. Sudden surprise contributes to the majority of accidents.
4. You should read all the safety warnings and user instructions carefully before attempting to operate this product.

To avoid kickback:

- Never work with a loose, widely stretched or heavily worn chain.
- Always use a low kickback chain.
- Ensure correct chain tension.
- Ensure the chain is sharpened correctly.
- Never work with the tip of the guide bar.
- Saw with the guide bar at a flat angle.
- Always hold the product firmly with both hands.

Pruning

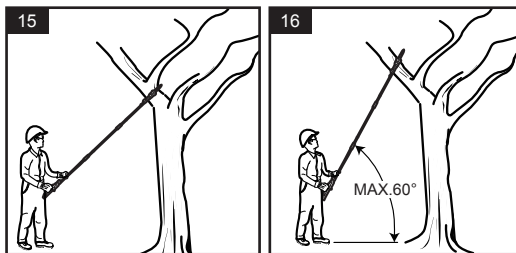

1. Always hold the product firmly with both hands on gripping surface (8) and rear handle (14). Never operate this product using only one hand (Fig. 15).
2. Maintain a firm grip with your thumbs and fingers encircling the handles. A firm grip will help you reduce 'kickback' and maintain control of the product.

- Always hold the product at an angle of not more than 60° from the horizontal level. Otherwise safe operation is not possible (Fig. 16).
- Never stand directly under the limb you are sawing. Objects may fall different than expected. Always position yourself out of the path of falling limbs (Fig. 17).
- Keep other persons away from cutting end of product and at a safe distance from the work area. Maintain a minimum distance of 10 m to bystanders (Fig. 18).

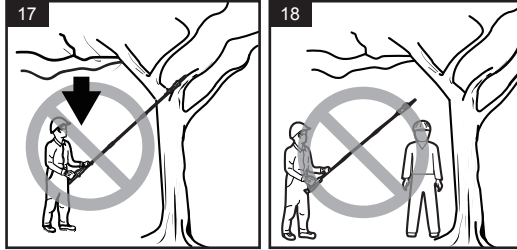

WARNING! Never climb into a tree to prune! Do not stand on ladders, platforms, logs, or in any position which may cause you to lose your balance or control of the product! When pruning trees, it is important not to make the flush cut next to main limb or trunk until you have cut off the limb further out to reduce the weight! This prevents stripping the bark from the main member!

- Never stand on a ladder or other type of unstable support while using the product. Insecure stand invites hazards.



WARNING! This product has not been designed to provide protection from electric shock in the event of contact with overhead electric lines! Therefore do not use product near cable, electric power or telephone lines. Keep a minimum distance of 10 m to all electric lines (Fig. 19).

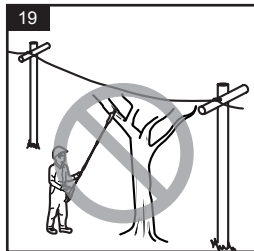

- Use the product only with secure footing. Hold the product at the right-hand side of your body. Regularly change the working position and include rest periods during operation.
- Do not operate the product with arms fully extended or attempt to cut areas which are difficult to reach.
- Keep a firm, steady pressure on the product while working with it. Do not try to force the product through the wood, let the cutting device do the work, using the gripping teeth to apply minimal leverage pressure.

10. Beware when reaching the end of the cut. The weight of the product may change unexpectedly as it cuts free from the wood. Accidents can occur to the legs and feet. Always remove the product from a wood cut while it is running.



NOTE: The chain must be running at full speed before it comes into contact with the wood.

Thin branches

Thin branches can be cut off with one single cut. To prevent the branch from slivering and buckling the branch should be cut off in several pieces (Fig. 20).

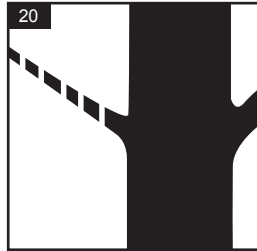

Thick branches

When cutting off larger branches three cuts are necessary.

1. First cut into the branch from below outside the place where you intend to cut off the branch. The cut should go from one third to halfway through the branch (Fig. 21).

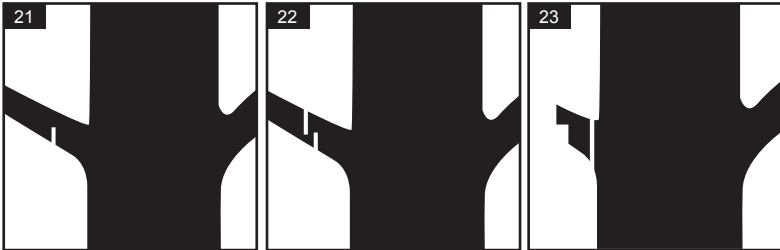

2. Cut into the branch from the top outside at the same height the branch is sawn from top (Fig. 22).
3. Last, cut off the stump with one clean cut from top to bottom (Fig. 23).
4. You might want to seal the cut with a suitable compound.



NOTE: Remove the branches lying on the floor regularly to avoid stumbling hazards. Check the oil level regularly and fill up if necessary. Switch the power off and disconnect from power source when leaving the product.

After use

1. Move the pole saw away from cutting area, and switch the product off.
2. Remove the battery pack and let the pole saw cool down.
3. Check, clean and store the product as described below.

EN Care and maintenance

The golden rules for care



WARNING! Always switch the product off, remove the battery pack and let the product cool down before performing inspection, maintenance and cleaning work!

1. Keep the product clean. Remove debris from it after each use and before storage.
2. Regular and proper cleaning will help ensure safe use and prolong the life of the product.
3. Inspect the product before each use for worn and damaged parts. Do not operate it if you find broken and worn parts.



WARNING! Only perform repairs and maintenance work according to these instructions! All further works must be performed by a qualified specialist! Improper maintenance may cause serious injuries.

General cleaning

1. Make sure the product is switched off, cooled down and the battery pack is removed.
2. Clean the product with a slightly damp cloth and mild soap. Use a brush for areas that are hard to reach.
3. In particular clean the air vents (21) after every use with a cloth and brush.
4. Remove stubborn dirt with high pressure air (max. 3 bar).
5. Cleaning and maintenance before storage.



NOTE: Do not use chemical, alkaline, abrasive or other aggressive detergents or disinfectants to clean this product as they might be harmful to its surfaces.

6. Check for any damage and wear. Repair damages in accordance with this instruction manual or take it to an authorised service centre before using the product again.

Sprocket wheel



NOTE: It is not necessary to remove the saw chain (6) to lubricate the sprocket wheel. Lubrication can be done on the job.

1. Clean the sprocket wheel (3).
2. Using a disposable lube gun, insert the needle nose into the lubrication hole (Fig. 24, A)

and inject grease until it appears at the outside edge of the sprocket (3) (Fig. 24).

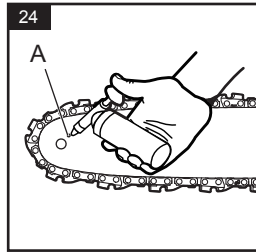

3. Rotate the saw chain (2) by hand. Repeat the lubrication procedure until the entire sprocket (3) has been greased.

Guide bar

Most guide bar problems can be prevented merely by keeping the product well maintained. Incorrect filling and non-standard cutter and depth gauge settings are the causes of most guide bar problems, primarily resulting in uneven bar wear. As the bar wears unevenly, the rails widen, which may cause the chain to clatter and make it difficult to complete straight cuts. If the guide bar is insufficiently lubricated and the product is operated with a saw chain which is too tight, this will contribute to rapid bar wear. To help minimise bar wear, maintenance of the guide bar as well as the saw chain is recommended.

1. Disassemble the guide bar and saw chain according to the section “Removing the guide bar and saw chain”.
2. Check the oiling port (26) for clogging and clean if necessary to ensure proper lubrication of the guide bar and saw chain during operation. Use a soft wire small enough to insert into the oil discharge hole (Fig. 25).

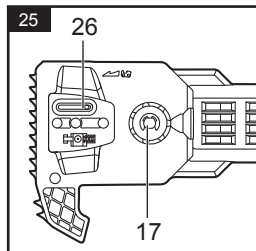

NOTE: The condition of the oil passages can be easily checked. If the passages are clear, the chain will automatically give off a spray of oil within seconds of the product starting. Your product is equipped with an automatic oiling system.

3. Check the drive sprocket (17). If it is worn or damaged due to strain, have it replaced by an authorised service agent.

4. Clear residue from the rails on the guide bar (1) by using a screwdriver, putty knife, wire brush or other similar tool. This will keep the oil passages open to provide proper lubrication to the bar (1) and chain (2) (Fig. 26)

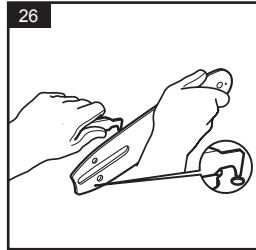

5. Check the guide bar 'rail' for wear: Hold a ruler (straight edge) against the side of the guide bar and 'cutter side plates'. If there is a gap between the ruler and guide bar the guide bar 'rail' is normal. If there is no gap (ruler flush against the side of the guide bar) the guide bar 'rail' is worn and needs to be replaced with a new one of the same type (Fig. 27)

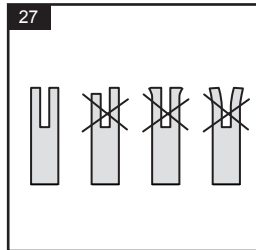

6. Check the saw chain for possible wear and damages. Replace it with a new one if required. Experienced user can sharpen a dull saw chain (see section "Saw chain sharpening" below).
7. Refit the saw chain (2) and the guide bar (1) as described under "Assembly".



NOTE: If the chain gets loose, turn the side cover knob counterclockwise to release the tension pin, then fully tighten the knob clockwise. The chain will automatically tighten appropriately.

Saw chain sharpening



NOTE: Never saw with a blunt chain. The saw chain is blunt if you have to push the product into the tree and the chips are very small.

1. Have the saw chain (2) sharpened professionally at an authorised service centre or sharpen the chain yourself by using a proper sharpening kit. Also observe the sharpening instructions supplied with the sharpening kit.



WARNING! Only sharpen the saw chain yourself if you are trained and have experience! Use proper tools to sharpen the saw chain!

2. The height difference between the tooth and the ridge is the cutting depth. When sharpening the saw chain (2) you have to consider the following points (Fig. 28).

- File angle
- Cutting angle
- File position
- Diameter of round file
- File depth

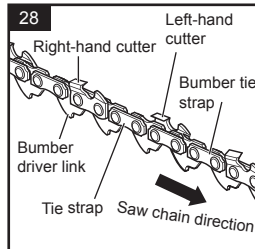

3. To sharpen the chain proceed as follows:

- Use protective gloves.
 - Ensure the chain is correctly tensioned.
 - Engage the chain brake to lock the chain on the bar.
4. Use a chain file, whose diameter is 1.1 times the cutting tooth depth. Make sure 20% of the file diameter is above the cutter's top plate.



NOTE: A file guide is available from most reputable tool merchants and is the easiest way to hold the file at the correct position.

5. File at an angle perpendicular to the bar, and at an angle of 25° to the direction of travel (Fig. 29).

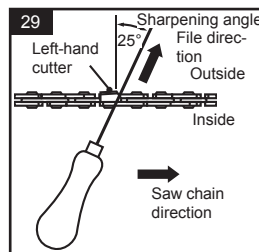

6. File each tooth from the inside towards outside only. File one side of the chain first than turn the saw around and repeat the process.
7. Sharpen each tooth equally by using the same number of strokes.
8. Keep all cutter lengths equal. Check the safety depth gauge height every 5 sharpenings. If the depth gauges are also trimmed it is essential that the original profile be restored.

9. Use a depth gauge measuring instrument to check the height of the depth gauge. Depth gauge measuring jigs are available from most reputable tool merchants (Fig. 30).

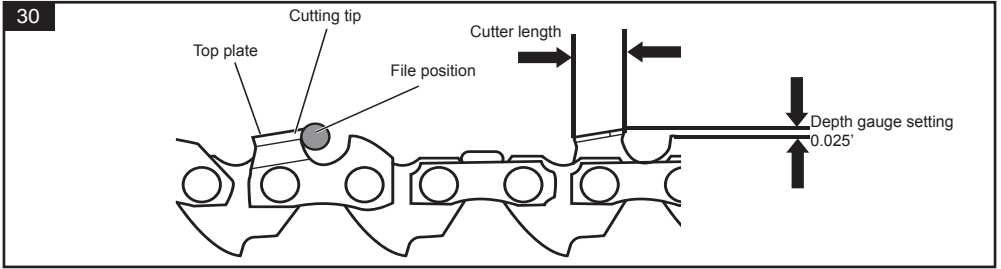

Spare parts / Replacement parts

The following parts of this product may be replaced by the consumer. Spare parts are available at an authorised dealer or through our customer service.

Description	Model no. or Specification
Saw chain	Oregon 80TXL038X
Guide bar	Oregon 084BXNA041



WARNING! Use non-conforming replacement components, or the removal or modification of safety components may cause serious injuries.

Repair

This product does not contain any parts that can be repaired by the consumer. Contact an authorized service centre or a similarly qualified person to have it checked and repaired.

Storage

1. Clean the product as described above.
2. Store the product and its accessories in a dry, frost-free, well-ventilated place.
3. Always store the product in a place that is inaccessible to children. The ideal storage temperature is between 10 and 30°C.
4. We recommend using the original package for storage to protect it against dust.



WARNING! Always charge the battery pack before storage! Please charge the battery pack to 3 bars on the battery light indicator. If the tool will not be used for long periods of time, charge the battery pack every 3-6 months. It is important to disconnect the charger from the power supply after charging has finished. Cool down battery pack from a just-operated product for approximately 20 minutes before attempting to recharge!

Transportation

1. Switch the product off and remove the battery pack.

2. Attach transportation guards, if applicable.
3. Always carry the product on its handles.
4. Protect the product from any heavy impact or strong vibrations which may occur during transportation in vehicles.
5. Secure the product to prevent it from slipping or falling over.

Troubleshooting

Suspected malfunctions are often due to causes that the users can fix themselves. Therefore check the product using this section. In most cases the problem can be solved quickly.



WARNING! Only perform the steps described within these instructions! All further inspection, maintenance and repair work must be performed by an authorised service centre or a similarly qualified specialist if you cannot solve the problem yourself!

Problem	Possible cause	Solution
1. Product does not start	1.1. Battery pack is not properly attached	1.1. Attach properly
	1.2. Battery pack is discharged	1.2. Remove and charge battery pack
	1.3. Battery pack is damaged	1.3. Check by a specialist electrician
	1.4. Other electrical defect to the product	1.4. Check by a specialist electrician
2. Product does not reach full power	2.1. Battery pack capacity is too low	2.1. Charge battery pack
	2.2. Air vents are blocked	2.2. Clean the air vents
3. Unsatisfactory cutting performance	3.1. Saw chain not tensioned properly	3.1. Tension properly
	3.2. Saw chain is dull/ damaged	3.2. Sharpen or replace the saw chain
4. Product suddenly stops	4.1. Battery pack is discharged	4.1. Remove and charge battery pack
	4.2. Battery pack is too hot	4.2. Remove battery pack and let it cool down
	4.3. Cutting device is blocked	4.3. Remove blockage
5. Excessive Vibration or noise	5.1. Saw chain is dull/ damaged	5.1. Sharpen or replace the saw chain
	5.2. Bolts/nuts are loose.	5.2. Tighten bolts/nuts

Recycling and disposal



Waste electrical products should not be disposed of with household waste. Please recycle where facilities exist. Check with your Local Authority or local store for recycling advice.

For further information visit www.recycle-more.co.uk.

The product comes in a package that protects it against damage during shipping. Keep the package until you are sure that all parts have been delivered and the product is working properly. Recycle the package afterwards.

Disposal of an exhausted battery pack



The battery is Li-Ion type. To preserve natural resources, please recycle or dispose of the battery pack properly. Consult your local waste authority for information regarding available recycling and / or disposal options.

Discharge your battery pack by operating your tool, then remove the battery pack from the tool and cover the battery pack connections with heavy duty adhesive tape to prevent short circuit and energy discharge.

Do not attempt to open or remove any of the components.

EN Guarantee

At **Erbauer** we take special care to select high quality materials and use manufacturing techniques that allow us to create ranges of products incorporating design and durability.

We carry out stringent testing procedures on all our tools and are confident that they can provide regular, sustained daily use during the period covered.

This power tool is guaranteed for 3 years from the date of purchase, if bought in store, delivered or bought online. You may only make a claim under this guarantee upon presentation of your sales receipt or purchase invoice. Please keep your proof of purchase in a safe place.

This guarantee covers product failures and malfunctions provided the **Erbauer** power tool was used for the purpose for which it is intended and subject to installation, cleaning, care and maintenance in accordance with standard practice and with the information contained above and in the user manual. This guarantee does not cover defects and damage caused by or resulting from:

- Normal wear and tear
- Overload, misuse or neglect
- Repairs attempted by anyone other than an authorized agent
- Cosmetic damage
- Damage caused by foreign objects, substances or accidents
- Accidental damage or modification
- Failure to follow manufacturer's guidelines
- Loss of use of the goods

This guarantee is limited to parts recognised as defective. It does not, in any case, cover ancillary costs (movement, labour) and direct and indirect damage. If the **Erbauer** power tool is defective during the guarantee period, then we reserve the right, at our discretion, to replace the item with a product of equivalent quality and functionality or to provide a refund.

This guarantee only applies to the country of purchase or delivery and is not transferrable to any other countries. This guarantee is non-transferrable to any other person or product. Relevant local law will apply to this guarantee.

Guarantee related queries should be addressed to a store affiliated with the distributor from where you purchased the **Erbauer** power tool.

Erbauer battery and charger are guaranteed for 2 years and covered by all others terms within the above guarantee.

This guarantee is in addition to and does not affect your statutory rights relating to faulty goods as a consumer.

Manufacturer:

Kingfisher International Products Limited
1 Paddington Square, London, W2 1GG, United Kingdom www.kingfisher.com/products

Distributor:

B&Q plc
Chandlers Ford, Hants, SO53 3LE, United Kingdom
www.diy.com

Screwfix Direct Limited
Trade House, Mead Avenue, Yeovil, BA22 8RT, United Kingdom
www.screwfix.com

**IMPORTANT - RETAIN THIS
INFORMATION FOR FUTURE
REFERENCE: READ CAREFULLY**

EN Customer care and technical helpline

A better way to repair your tools

Kingfisher takes special care in creating high-quality garden power tools that are designed to last. But if a fault develops with your garden power tool and you need to claim under the guarantee, the Customer Care and Technical Helpline can support with technical assistance or if required, arrange a free courier collection from your home, assess your garden power tool for fault, repair it, and return it.

Deciding to repair your product rather than buying a replacement and adding to the mountain of waste is a more sustainable choice and you will be doing your bit for the environment.

How does it work?



NOTE: Before collection, all fuel must be removed from petrol powered machines.

Get in touch

If you need help or more information, please contact the Customer Care and Technical Helpline:

UK 0330 678 3077

ROI 1 800 365 800

Opening hours are Monday – Friday, 8am-5pm

Availability of spare parts

Contact the customer service helpline for assistance or visit www.kingfisherspares.com

For assistance contact the customer services helpline:

UK 0800 0789647 uk@kingfisherservice.com

EIRE 1800 932226 eire@kingfisherservice.com

Further information about this product can also be found at:

www.kingfisher.com/products



EN Declaration of conformity



(EN) EU DECLARATION OF CONFORMITY
 (FR) DÉCLARATION UE DE CONFORMITÉ
 (PL) DEKLARACJA ZGODNOŚCI UE
 (RO) DECLARAȚIA DE CONFORMITATE UE
 (ES) DECLARACIÓN UE DE CONFORMIDAD
 (PT) DECLARAÇÃO DE CONFORMIDADE UE

Product/ Produit/ Produkt/Produsul/Producto/Producto

- Cordless pole saw/ xx / xx / xx / xx / xx
- 84017/ERI1020PLS
- Serial number 00001-99999

Name and address of the manufacturer or his authorised representative:

Nom et adresse du fabricant ou de son mandataire:

Nazwa i adres producenta lub jego upoważnionego przedstawiciela:

Denumirea și adresa producătorului sau a reprezentantului său autorizat:

Nombre y dirección del fabricante o de su representante autorizado:

Nome e endereço do fabricante ou do respetivo mandatário:

Kingfisher International Products B.V.,
 Rapenburgerstraat 175E,
 1011 VM Amsterdam,
 The Netherlands

This declaration of conformity is issued under the sole responsibility of the manufacturer.

La présente déclaration de conformité est établie sous la seule responsabilité du fabricant.

Niniejsza deklaracja zgodności wydana zostaje na wyłączną odpowiedzialność producenta.

Prezenta declarație de conformitate este emisă pe răspunderea exclusivă a producătorului.

La presente declaración de conformidad se expide bajo la exclusiva responsabilidad del fabricante.

A presente declaração de conformidade é emitida sob a exclusiva responsabilidade do fabricante.

Object of the declaration/Objet de la declaration/Przedmiot deklaracji/Obiectul declarației/Objeto de la declaración/Objeto da declaração

Product/Produit/Produkt/Produsul/Producto/ Produto

Model/Modèle/Model/Modelul/Modelo/ Modelo
 EAN

Cordless pole saw/ xx / xx / xx / xx / xx

84017/ERI1020PLS

The object of the declaration described above is in conformity with the relevant Union harmonisation legislation:

L'objet de la déclaration décrit ci-dessus est conforme à la législation d'harmonisation de l'Union applicable:

Wymieniony powyżej przedmiot niniejszej deklaracji jest zgodny z odpowiednimi wymaganiami unijnego prawodawstwa harmonizacyjnego:

Obiectul declarației descris mai sus este în conformitate cu legislația relevantă de armonizare a Uniunii: El objeto de la declaración descrita anteriormente es conforme con la legislación de armonización pertinente de la Unión:

O objeto da declaração acima descrito está em conformidade com a legislação de harmonização da União aplicável:

2006/42/EC as amended Machinery Directive
 2014/30/EU as amended Directive Electromagnetic compatibility
 2000/14/EC as amended Outdoor Noise Directive
 2016/1628/EU Regulation Gaseous and Particulate Pollutant Emission Limits
 2011/65/EU as amended Directive Restriction of the use of certain hazardous substances in electrical and electronic equipment
 Directive 2006/42/CE relative aux machines
 2014/30 / UE telle que modifiée Directive Compatibilité électromagnétique
 Directive 2000/14/CE relative aux émissions sonores extérieures
 Règlement (UE) 2016/1628 relatif aux exigences concernant les limites d'émission pour les gaz polluants et les particules polluantes
 Directive 2011/65/UE relative à la limitation de l'utilisation de certaines substances dangereuses dans les équipements électriques et électroniques
 2006/42/WE w zmienionej dyrektywie maszynowej
 2014/30 / UE ze zmianami Dyrektywa Kompatybilność elektromagnetyczna
 2000/14/WE w zmienionej dyrektywie w sprawie hałasu na zewnątrz
 2016/1628/UE limity emisji zanieczyszczeń gazowych i cząstek stałych
 2011/65 / UE ze zmianami Dyrektywa Ograniczenie stosowania niektórych niebezpiecznych substancji w sprzęcie elektrycznym i elektronicznym
 2006/42/CE, astfel a fost modificată Directiva privind echipamentele
 2014/30/UE, astfel a fost modificată Directiva privind compatibilitatea electromagnetică
 2000/14/CE, astfel a fost modificată Directiva privind zgomotul în aer liber
 2016/1628/UE Regulamentul privind emisiile de poluanți gazeși și de particule poluante
 2011/65/UE, astfel a fost modificată Directiva privind limitarea utilizării anumitor substanțe periculoase în echipamentele electrice și electronice
 Directiva sobre maquinaria modificada 2006/42/CE
 2014/30/UE modificada Directiva Compatibilidad electromagnética
 2000/14/CE modificada Directiva sobre ruido al aire libre
 2016/1628/Reglamento de la UE Límites de emisiones de contaminantes gaseosos y partículas
 2011/65/UE modificada Directiva Restricción del uso de determinadas sustancias peligrosas en equipos eléctricos y electrónicos
 2006/42/CE como diretiva de máquinas alteradas
 2014/30/UE como alteração da compatibilidade eletromagnética
 2000/14/CE como diretiva de ruído exterior alterada
 Limites de emissão de poluentes gasosos e de poluentes de partículas 2016/1628/REGULAMENTO da UE
 2011/65/UE como restrição diretiva alterada da utilização de certas substâncias perigosas em equipamentos elétricos e eletrônicos

[for items including a separate power supply or mains corded electrical add as applicable]

2014/35/EU Directive Electrical Safety: Low-voltage electrical equipment	
2014/35/EU Directive Sécurité électrique: matériel électrique à basse tension	
2014/35/EU Dyrektywa Bezpieczeństwo elektryczne: sprzęt elektryczny niskiego napięcia	
Directiva 2014/35/UE siguranța electrică: echipamente electrice de joasă tensiune	
2014/35/EU Directiva Seguridad Eléctrica: Equipos eléctricos de baja tensión	
2014/35/Diretiva UE Segurança Elétrica: Equipamento elétrico de baixa tensão	
Measured Sound Power Level	Guaranteed Sound Power Level
Le niveau de puissance acoustique mesuré	Le niveau de puissance acoustique garant
Zmierzony poziom mocy akustycznej	Gwarantowany poziom mocy akustycznej
Nivel de putere acustică măsurat	Nivel de putere acustică garantat
Nivel de potencia sonora medido	Nivel de potencia sonora garantizado
Nível de potência sonora medido	Nível de potência sonora garantido
: 93 dB(A)	: 94 dB(A)

References to the relevant harmonised standards used or references to the other technical specifications in relation to which conformity is declared:

Références des normes harmonisées pertinentes appliquées, y compris la date de celles-ci, ou des autres spécifications techniques, y compris la date de celles-ci, par rapport auxquelles la conformité est déclarée:

Odwolania do odnośnych norm zharmonizowanych, które zastosowano, wraz z datą normy, lub do innych specyfikacji technicznych, wraz z datą specyfikacji, w odniesieniu do których deklarowana jest zgodność:

Trimiteri la standardele armonizate relevante folosite, inclusiv data standardului, sau trimeri la celelalte specificații tehnice, inclusiv data specificațiilor, în legătură cu care se declară conformitatea:

Referencias a las normas armonizadas pertinentes utilizadas, incluidas las fechas de las normas, o referencias a las otras especificaciones técnicas, incluidas las fechas de las especificaciones, respecto a las cuales se declara la conformidad:

Referências às normas harmonizadas aplicáveis utilizadas, incluindo a data da norma, ou às outras especificações técnicas, incluindo a data da especificação, em relação às quais é declarada a conformidade:

EN 62841-1:2015+A11:2022

EN ISO 11680-1:2021

EN IEC 55014-1:2021

EN IEC 55014-2:2021

Authorised signatory and technical file holder/signataire et responsable de la documentation technique autorisé/ podmiot uprawniony do wystawienia i adres przechowywania dokumentacji technicznej/ semnatar autorizat și deținător al dosarului tehnic/firmante autorizado y titular del expediente tecnico/ signatário autorizado e detentor da ficha técnica

Kingfisher International Products B.V.,
Rapenburgerstraat 175E,
1011 VM Amsterdam,
The Netherlands



David Awe
Group Quality Director

30/07/2024



(UK) DECLARATION OF CONFORMITY

Product

- Cordless Pole saw
- 84017/ERI1020PLS
- Serial number 00001-99999

Name and address of the manufacturer or his authorised representative:

Kingfisher International Products Limited
1 Paddington Square
London
W2 1GG
United Kingdom

This declaration of conformity is issued under the sole responsibility of the manufacturer.

Object of the declaration

Product	Model
Cordless Pole saw	84017/ERI1020PLS

The object of the declaration described above is in conformity with the relevant legislation:

2006/42/EC as amended	Machinery Directive
2014/30/EU as amended	Directive Electromagnetic compatibility
2000/14/EC as amended	Outdoor Noise Directive
2011/65/EU as amended	Directive Restriction of the use of certain hazardous substances in electrical and electronic equipment

Measured Sound Power Level: 93 dB(A)

Guaranteed Sound Power Level: 94 dB(A)

References to the relevant designated standards used or references to the other technical specifications in relation to which conformity is declared:

EN 62841-1:2015+A11:2022	EN IEC 55014-1:2021
EN ISO 11680-1:2021	EN IEC 55014-2:2021
BS EN 62841-1:2015+A11:2022	BS EN IEC 55014-1:2021
BS EN ISO 11680-1:2021	BS EN IEC 55014-2:2021

Authorised signatory and technical file holder:

Kingfisher International Products Limited
1 Paddington Square
London
W2 1GG
United Kingdom

David Awe
Group Quality Director

On [30/07/2024]

Manufacturer :

UK Manufacturer:

Kingfisher International Products Limited,
1 Paddington Square, London, W2 1GG,
United Kingdom

EU Manufacturer:

Kingfisher International Products B.V.
Rapenburgerstraat 175E
1011 VM Amsterdam
The Netherlands

EN www.diy.com

www.screwfix.com

www.screwfix.ie

**To view instruction manuals online,
visit www.kingfisher.com/products**